



TYP AKUMULATORA: **Toyota – NPM105 12V
AGM Deep Cycle Battery**



Specyfikacja techniczna:

Napięcie		12 Volt
Pojemność		105 Ah
Wymiary	długość	307 mm
	szerokość	169 mm
	wysokość	211 mm
	całkowita wys.	215 mm
Masa akumulatora		30,5kg
Rodzaj obudowy		ABS
Rezystancja wewnętrzna		<5mΩ
Pojemność znamionowa	C-20 (1,75V/cell,25°C)	104 Ah
	C-5 (1,75V/cell,25°C)	79,5 Ah
	C-1 (1,60V/cell,25°C)	55,4 Ah
Zakres temperatur pracy	rozładowanie	-15 - 50°C
	ładowanie	0 - 40°C
	przechowywanie	-15 - 40°C
Pojemność w danej temperaturze	40°C	103%
	25°C	100%
	0°C	86%
samorozładowanie	po 3 mies.	92%
	po 6 mies.	84%
	po 12 mies.	65%

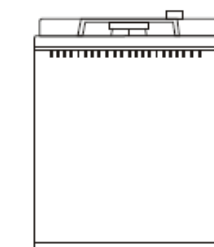
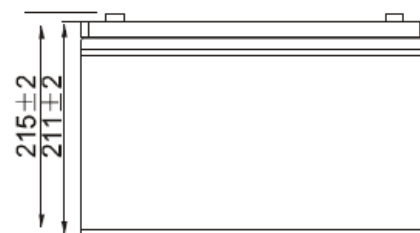
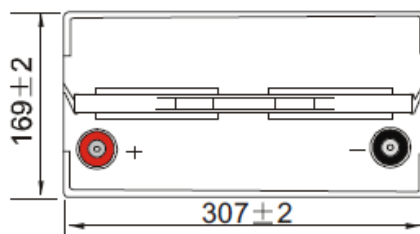

■ T3 Terminal
Unit: mm [inches]

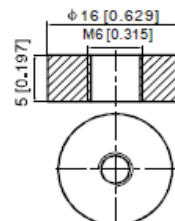

Praca cykliczna – maksymalny prąd ładowania nie wyższy niż 14A

Napięcie ładowania 14,4V-15V w temp. 25°C. Korekta -30mV/°C

Napięcie ładowania 13,5V-13,8V w temp. 25°C. Korekta -20mV/°C

Tabela rozładowania stałym prądem (Amper) 25°C

Constant Current Discharge (Amperes) at 25°C (77°F)															
F.V/Time	5min	10min	15min	20min	30min	45min	1h	2h	3h	4h	5h	6h	8h	10h	20h
1.85V/cell	154.0	121.1	103.0	86.1	68.5	51.8	42.4	27.0	21.4	17.5	14.1	12.2	9.95	8.50	4.64
1.80V/cell	206.8	154.7	124.4	101.8	80.8	60.3	47.5	29.5	23.0	18.6	15.1	13.1	10.5	9.00	5.00
1.75V/cell	233.1	170.0	135.9	109.5	83.9	62.5	49.7	30.6	23.4	19.1	15.5	13.5	10.7	9.09	5.20
1.70V/cell	256.7	185.3	145.1	115.1	87.3	65.0	51.3	31.8	24.1	19.6	15.9	13.8	10.9	9.18	5.30
1.65V/cell	283.1	200.0	154.3	122.3	92.1	66.7	53.0	32.7	25.1	20.2	16.3	14.1	11.1	9.37	5.40
1.60V/cell	312.2	217.1	165.0	130.3	97.2	69.5	54.9	33.8	25.9	20.9	16.9	14.4	11.2	9.47	5.50

Tabela rozładowania mocą (Watt) 25°C

Constant Power Discharge (Watts/cell) at 25°C (77°F)															
F.V/Time	5min	10min	15min	20min	30min	45min	1h	2h	3h	4h	5h	6h	8h	10h	20h
1.85V/cell	281.6	223.7	192.2	162.4	130.5	99.6	81.8	52.5	41.6	34.1	27.6	24.1	19.6	16.8	9.18
1.80V/cell	374.0	282.5	229.1	189.1	151.6	114.9	91.2	56.9	44.6	36.2	29.5	25.7	20.8	17.8	9.26
1.75V/cell	412.7	305.4	247.1	201.5	156.1	118.1	95.0	58.8	45.2	36.9	30.2	26.4	21.1	17.9	9.33
1.70V/cell	441.9	325.3	260.2	210.2	161.6	122.4	97.6	61.0	46.4	37.8	30.9	26.9	21.3	18.1	9.51
1.65V/cell	480.4	347.9	274.5	221.6	169.1	124.3	100.2	62.3	48.1	39.0	31.6	27.4	21.6	18.4	9.62
1.60V/cell	517.6	369.1	288.7	233.5	177.2	128.9	103.2	64.1	49.4	40.1	32.5	27.9	21.8	18.6	9.66

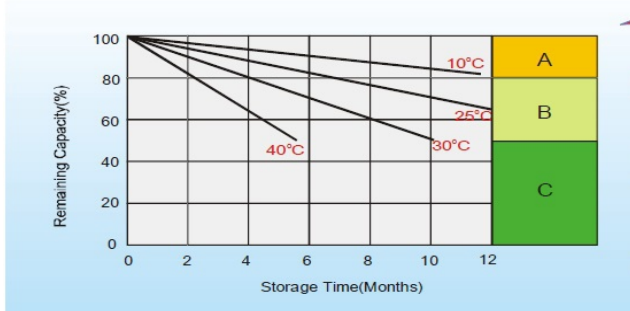
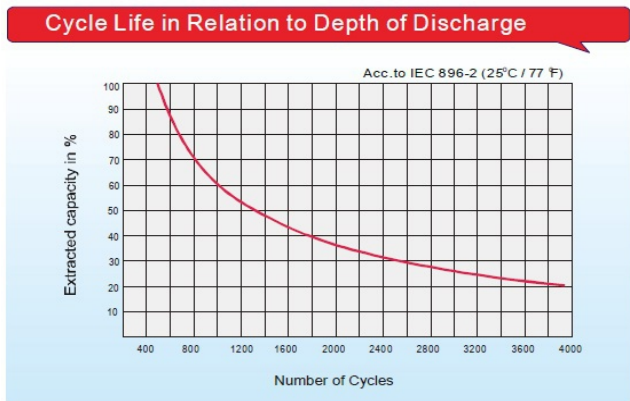
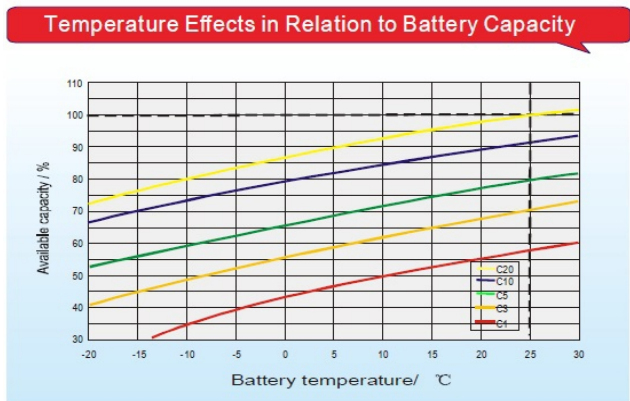
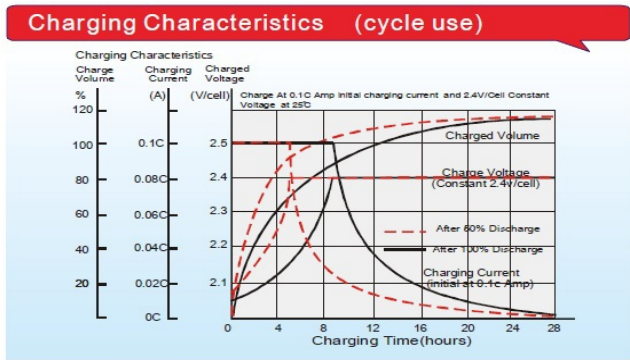
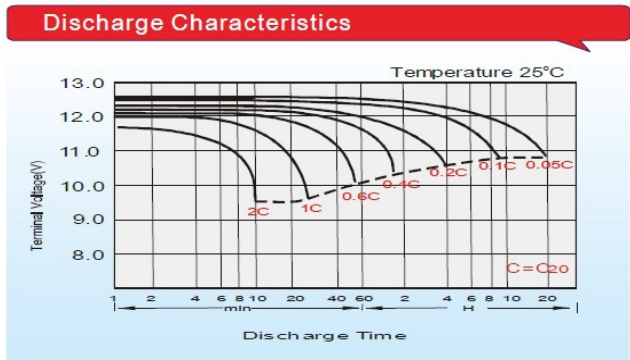

- Self Discharge Characteristics**
- A** No supplementary charge required
(Carry out supplementary charge before use if 100% capacity is required.)
 - B** Supplementary charge required before use. Optional charging way as below:
 1. Charged for above 3 days at limited current 0.25CA and constant volatge 2.25V/cell.
 2. Charged for above 20hours at limited current 0.25CA and constant volatge 2.45V/cell.
 3. Charged for 8-10hours at limited current 0.05CA .
 - C** Supplementary charge may often fail to recover the capacity.
The battery should never be left standing till this is reached.